

# ARC

AEROSPACE RESEARCH CAMPUS

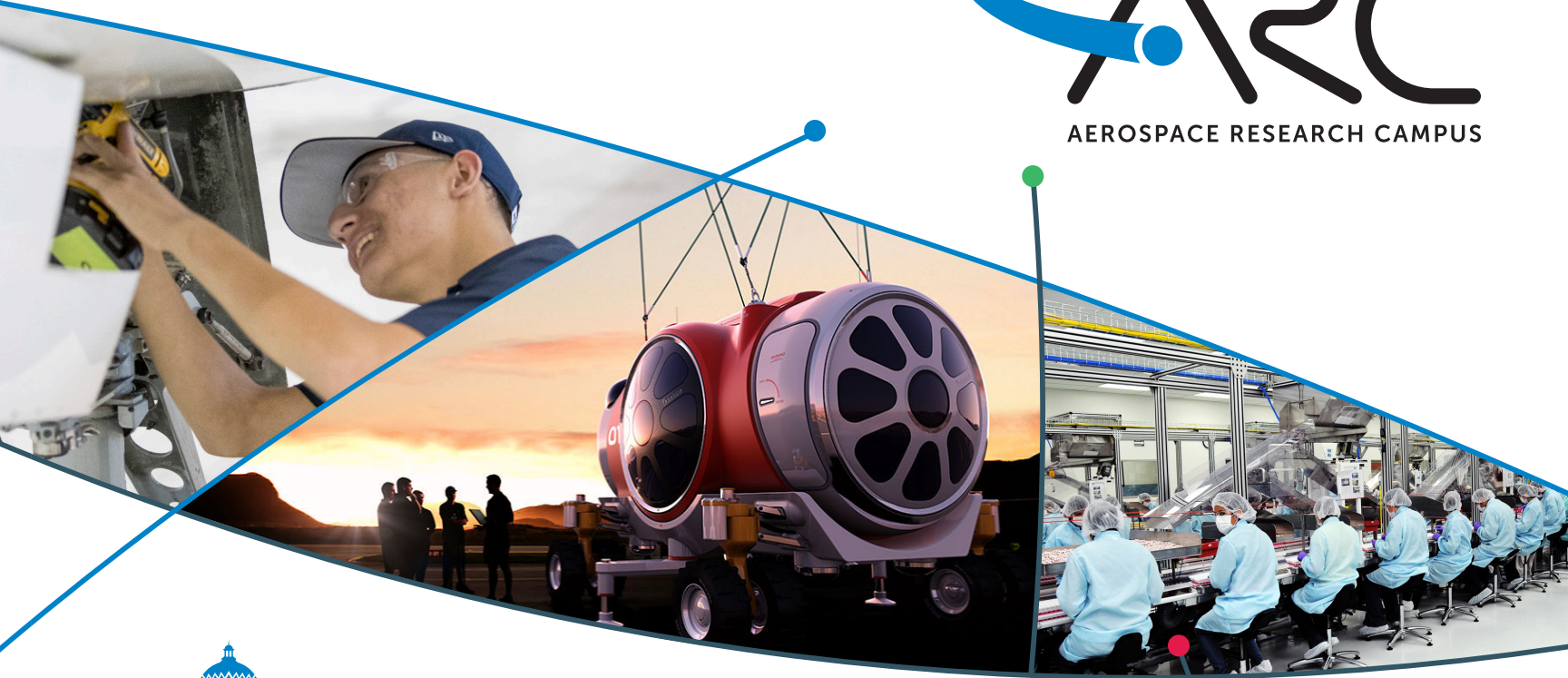

# Pima County Aerospace Research Campus (ARC)

The development site has full access to utilities, is accessible to various modes of transportation, and is in close proximity to other important economic drivers for the region. The maps below illustrate two points of view, with the one on the right providing intricate detail of utility lines and available acreage.

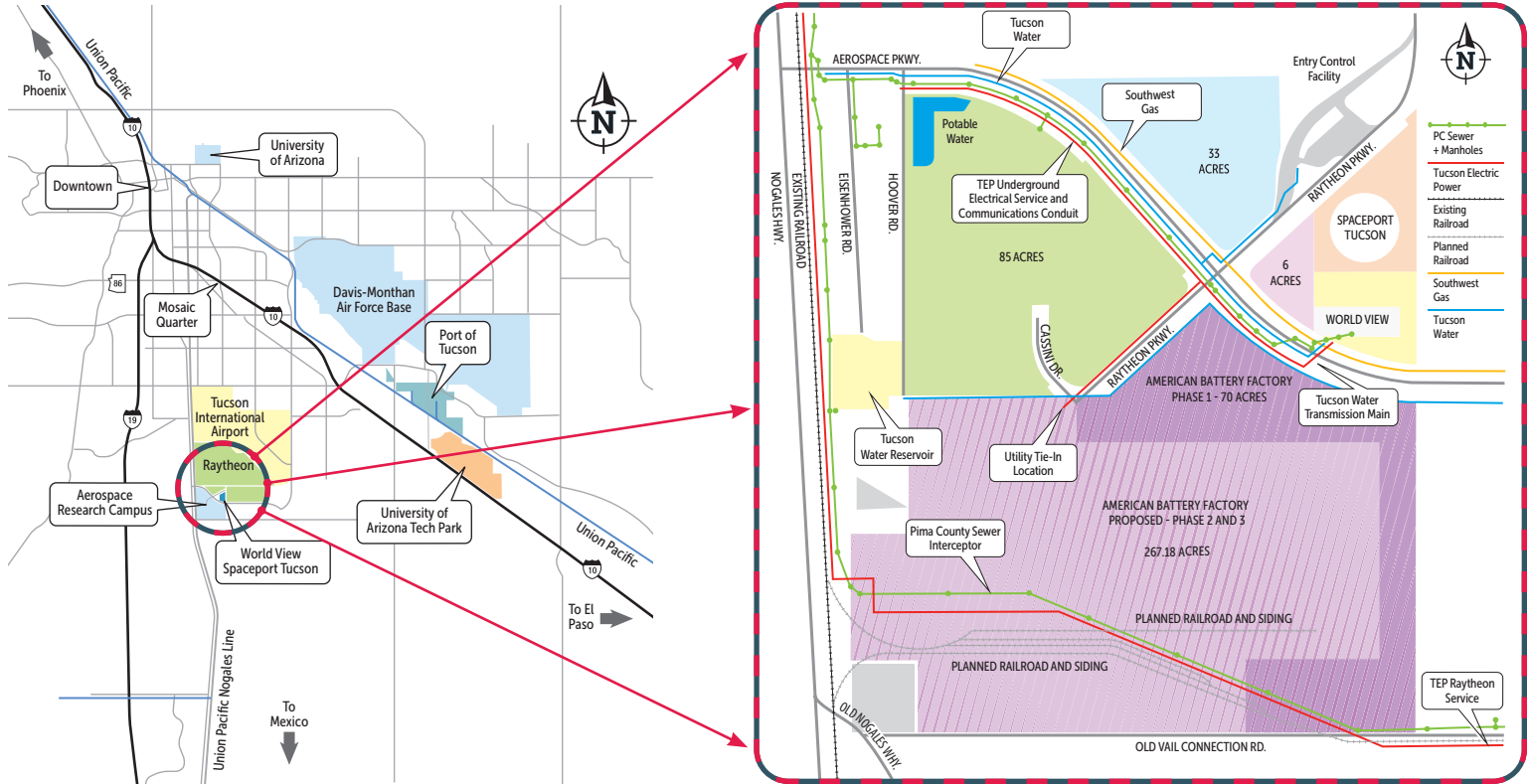

# About the property

Ideally located between two major interstate routes, the (ARC) is a fully improved, shovel-ready site, consisting of 400+ acres of configurable land, and featuring newly constructed water, wastewater, drainage, electric and telecom infrastructure.

Due to its strategic location and proximity to two major interstate routes, the Union Pacific Railroad, the Port of Tucson, and Tucson International Airport, as well as the presence of both Raytheon Technologies and World View Enterprises business campuses, ARC is the perfect site for major development related to Transportation, Distribution and Logistics, Aviation and Aerospace R&D, Space & Near-Space Technology, Natural Resources Technology, Advanced Manufacturing, Clean and Renewable Energy and more.



*World View launches a high altitude monitoring system from Spaceport Tucson.*



# Our Tenants

## World View Enterprises

A local company founded in 2012 that develops and flies proprietary high-altitude unmanned flight systems for tourism, commercial, government, remote sensing, and research purposes. World View's innovative technology develops high altitude balloons capable of lifting various types of payloads to the stratosphere. The company has conducted more than 100 flights to date. World View has 100+ employees.



## Raytheon Missile Systems

A Tucson-area mainstay in the aerospace and defense industry for decades, the company is the largest private employer in the region. Raytheon has expanded its workforce significantly with more than 13,000 employees in Pima County, many working in high-paying engineering and technical fields.





## Site Details

**Acreage:** 400+, configurable.

**Zoning:** Pima County I-2 (Industrial).

**Water** – On-site Access, High Capacity.  
Provider = City of Tucson.

**Wastewater** – On-site Access, High Capacity. Provider = Pima County.

**Drainage** – On-site Access.

**Electric** – Full Access, Variable Capacity.  
Provider = Tucson Electric Power.

**Internet** – Full Access, High-speed Capacity. Multiple Provider Options.

## Location Highlights

Proximity to Raytheon Technologies, World View Enterprises, Spaceport Tucson, Downtown Tucson, UA Tech Park, Interstate 10, Interstate 19, Union Pacific Railroad, Port of Tucson, Tucson International Airport, California ports, Texas, and Mexico.

# Transportation Access

- Interstate 19 and Interstate 10; future transportation infrastructure plans include auxiliary Interstate connecting I-10 and I-19
- Rail: Siding designed and approved for rail access onto property
- Tucson International Airport - 5mi
- Marana Regional Airport - 30mi
- Phoenix Sky Harbor International Airport - 120mi
- Port of Tucson - 10mi
- Nogales Port of Entry - 60mi
- Port of Long Beach - 8hrs



## Incentives

- Foreign Trade Zone 174
- Additional information available upon request





**Board of Supervisors**

Adelita S. Grijalva, *Chair*, District 5

Rex Scott, *Vice Chair*, District 1

Dr. Matt Heinz, District 2

Sharon Bronson, District 3

Steve Christy, District 4

**Pima County Administrator**

Jan Leshner





**PIMA COUNTY**  
ECONOMIC DEVELOPMENT

Heath Vescovi-Chiordi, MPA  
Director  
201 N Stone Ave., 2nd Floor  
Tucson, AZ 85701-1317  
(520) 724-4444

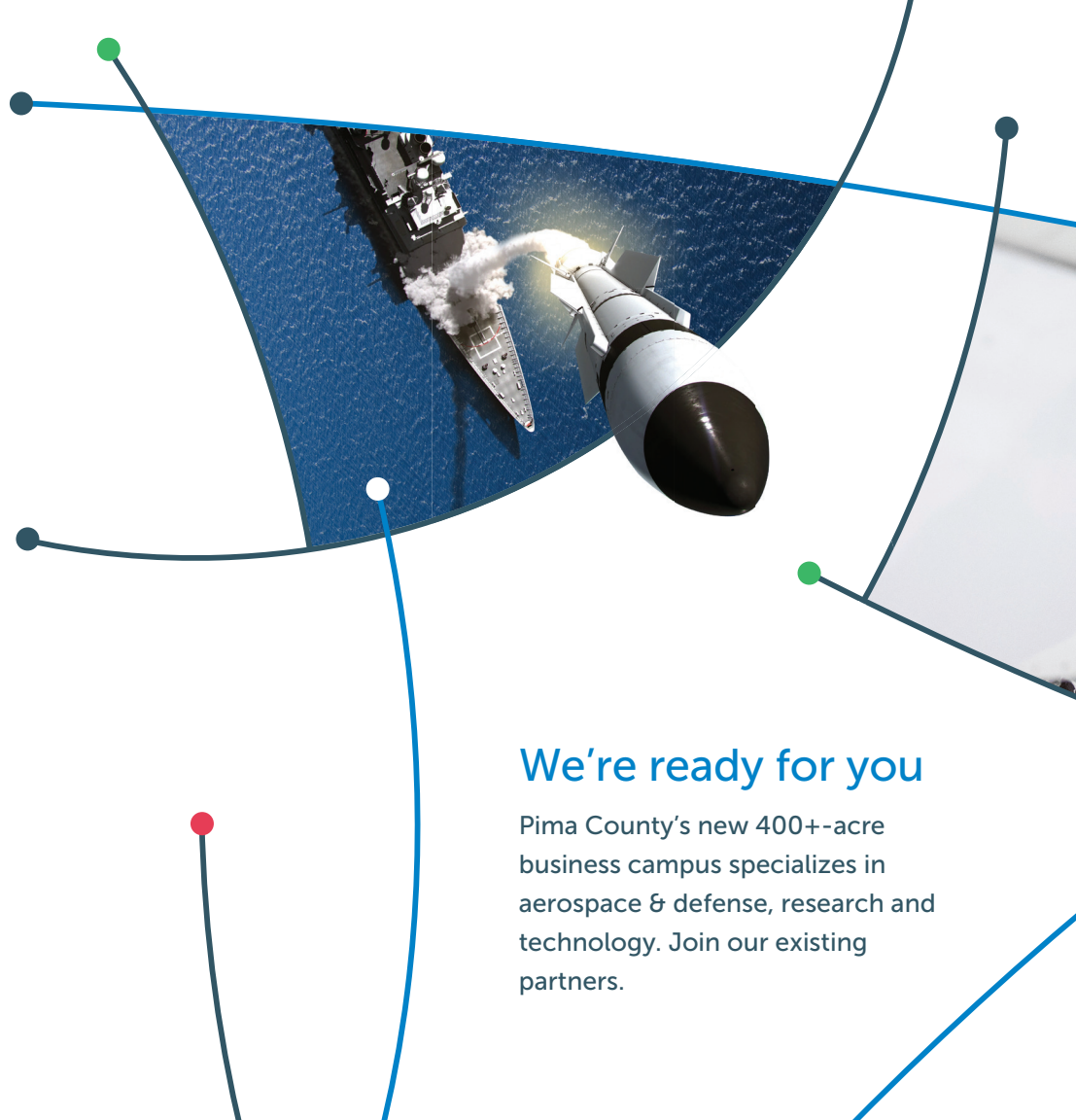

## We're ready for you

Pima County's new 400+-acre business campus specializes in aerospace & defense, research and technology. Join our existing partners.